

# ELDERSBURG:

What do you want to see on this property near the intersection of Sykesville and Liberty Roads?

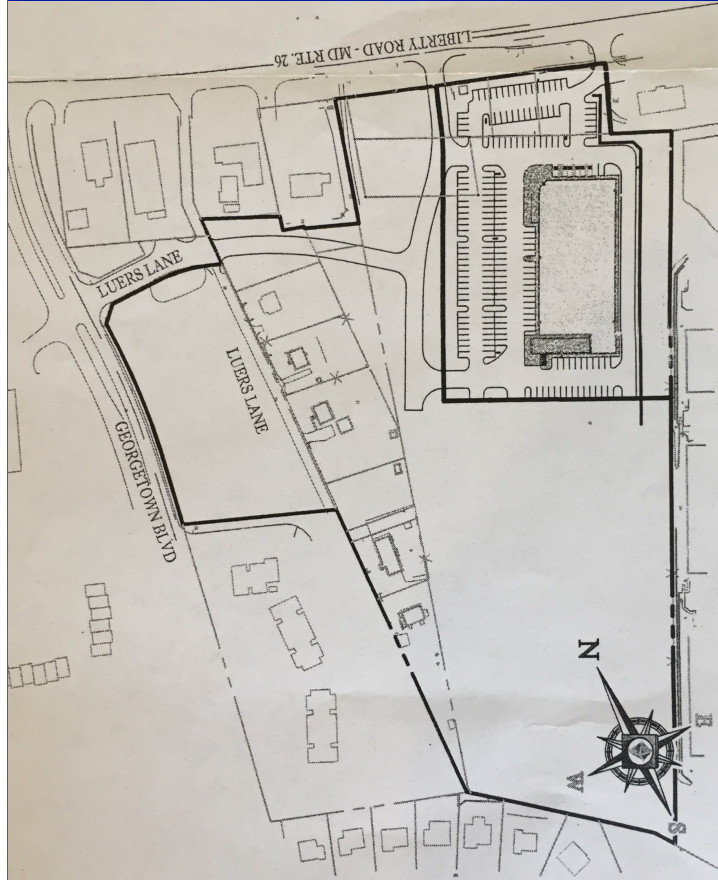

Martin's, Safeway, Shoppers, ALDI, Walmart, Weis – and now a new LIDL?

How many jobs will be lost if grocery stores at other shopping centers nearby cut back or close?

Does Eldersburg really need a 7th full-size grocery store? From the community's point of view, is this really the highest and best use of an important property? Would a grocery store even be consistent with the purpose of the property's zoning?

Please attend the meeting of the Planning and Zoning Commission at 6 PM on April 5 in Room 003 in the County building at 225 North Center St. in Westminster – and be sure to visit <http://EvenBetterPlaces.org/Eldersburg> for more information and to take our survey about this property. Thank you!